

Reproduced from the Ordnance Survey Mapping with the permission of the Controller of Her Majesty's Stationary Office, Crown copyright.
Vale of White Horse District Council
 Licence No. 100019525
South Oxfordshire District Council
 Licence No. 100018668

- NOTES:**
1. This drawing to be read in conjunction with all relevant drawings, documents and specifications.
 2. Dimensions not to be scaled from drawing.
 3. Dimensions are in millimetres unless otherwise stated.

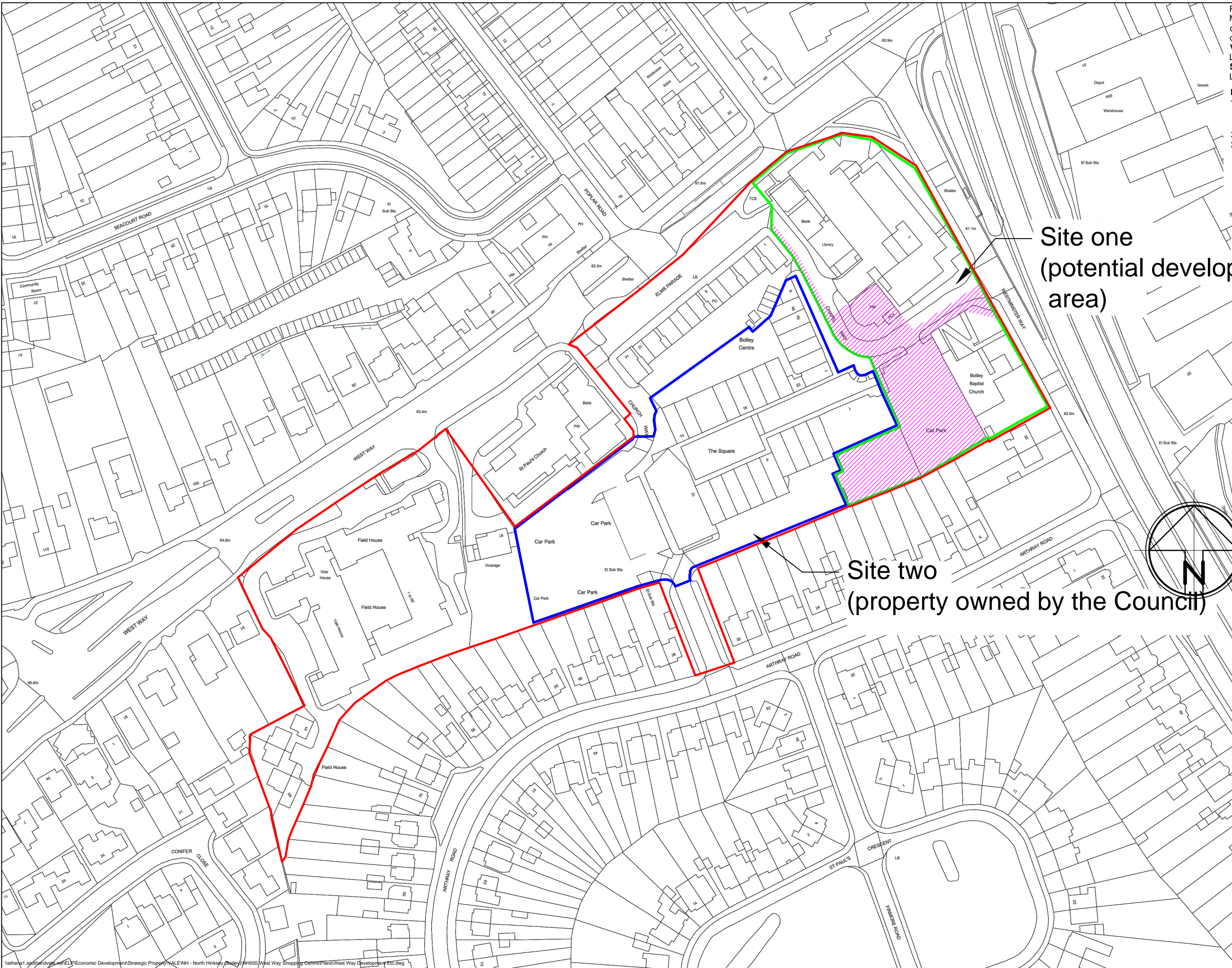

Site one
(potential development area)

Site two
(property owned by the Council)

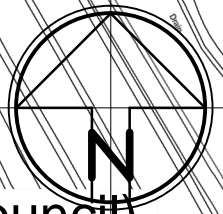

00		xx/08
Revision	Description	Date
Status:		
Shared Strategic Property Abbey House, Abbey Close ABINGDON, OXON OX14 3JE		
Client	South Oxfordshire District Council and Vale of White Horse District Council	
Contract	West Way Botley	
Title		
Suzanne Malcolm - Shared Economic Development Manager		
Division	Economy Leisure & Property	Plot Date 11/11/2013
Scale	Orig. No.	Rev.
Drawn by	Chk'd by	App by
RGE		